

REVISIONS					
REV.	DESCRIPTION	ECO	DRAWN	APPROVED	DATE
A1	Remove Clamp outlet 0.75C	-	Galy B.	Tzah. Gr.	26/12/2022

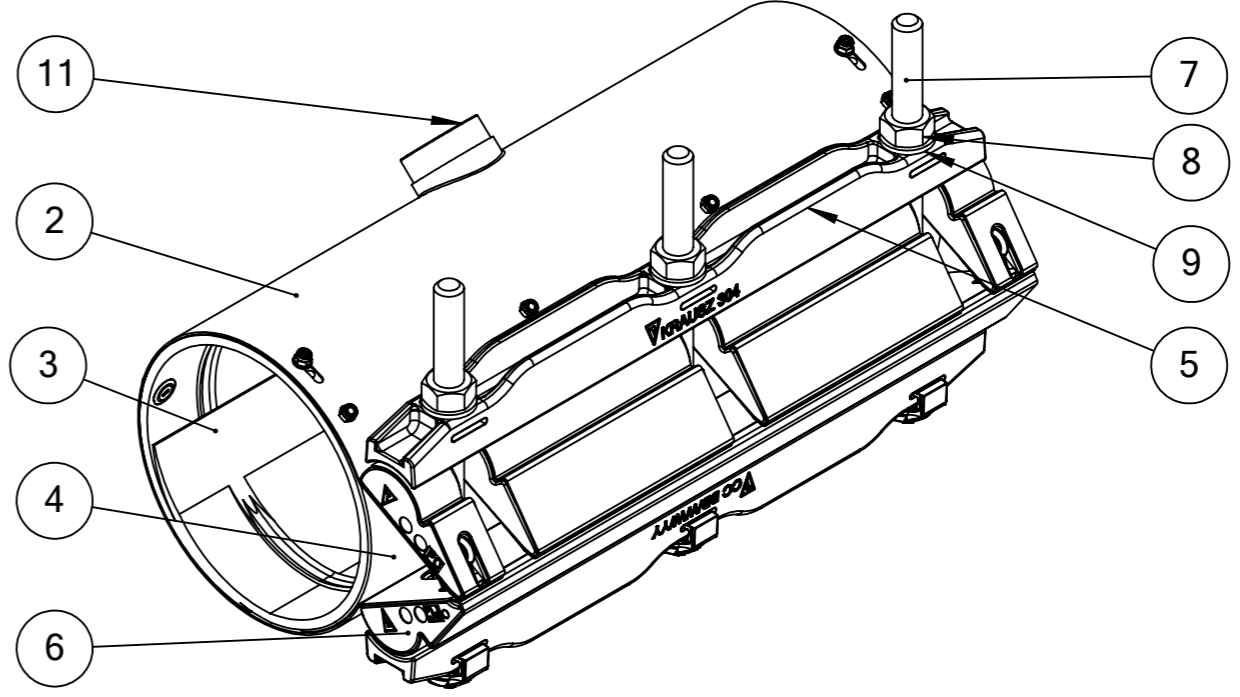

**Material information**

- 1.Hymax Clamp Outlet meets AWWA C230 standard.
- 2.Body - AISI 304 Stainless Steel  
ASTM A240 / ASTM A480.
- 3.Pressure Assisted Gasket - EPDM compounded for water and sewerage in accordance with ASTM D2000  
Working Temperature:  
For continuous operations: -20°F up to +180°F  
For short time operations: up to +215°F
- 4.Gasket Bridge - AISI 304 Stainless Steel ASTM A240.
- 5.Compression Beam - Casting AISI 304 of ASTM-A351-CF8.
- 6.Lugs - Polycarbonate.
- 7.Bolt- AISI 304 Stainless Steel ASTM F593.  
Rolled thread and anti-galling coating.
- 8.Nuts - AISI 304 Stainless Steel ASTM F594.  
Rolled thread and anti -galling coating.
- 9. Washers - AISI 304 Stainless Steel ASTM A240.
- 10.Adjusting Pin - Casting AISI-304 of ASTM-A351-CF8.
- 11.Thread Tap NPT/CC - AISI 304 Stainless Steel .

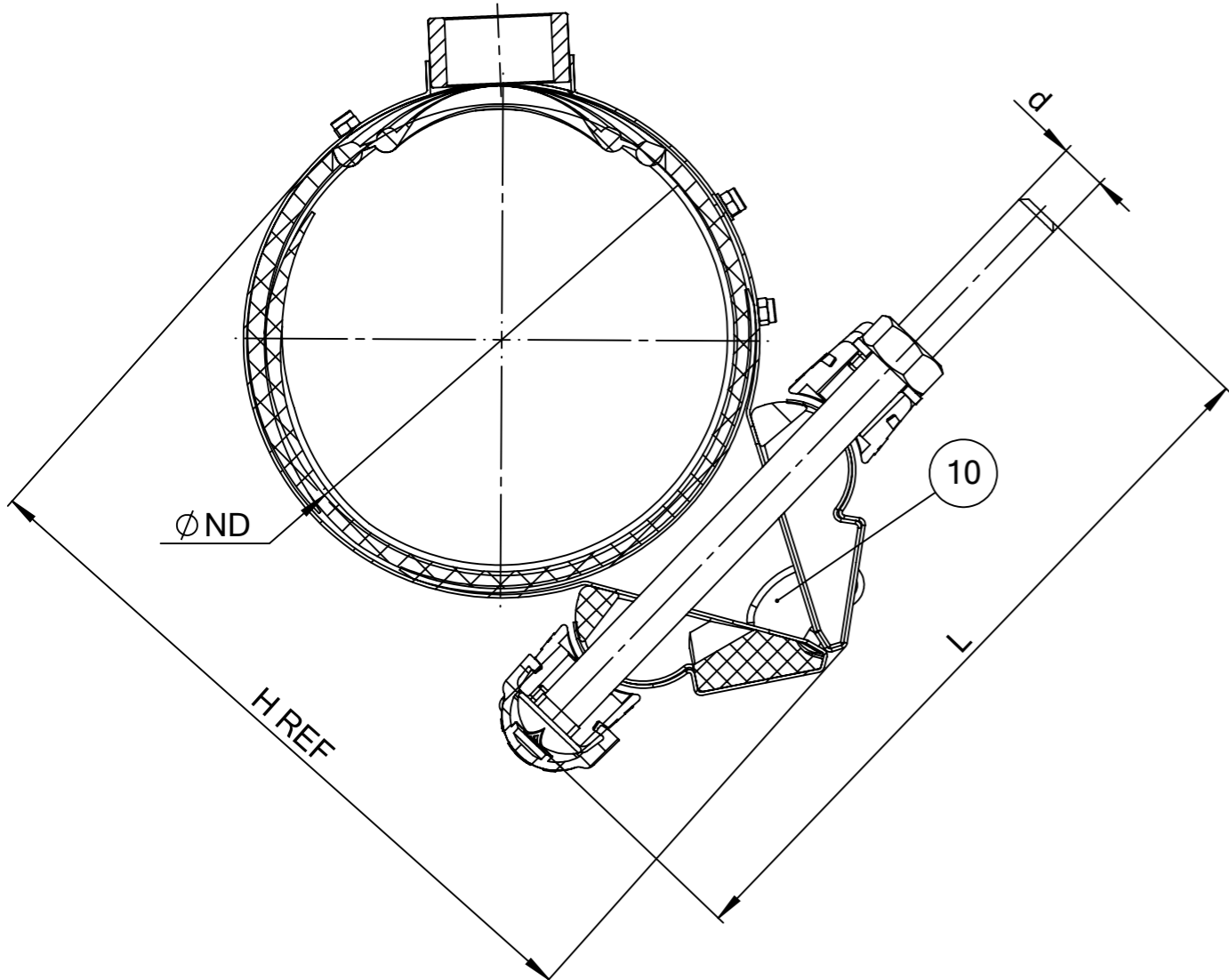
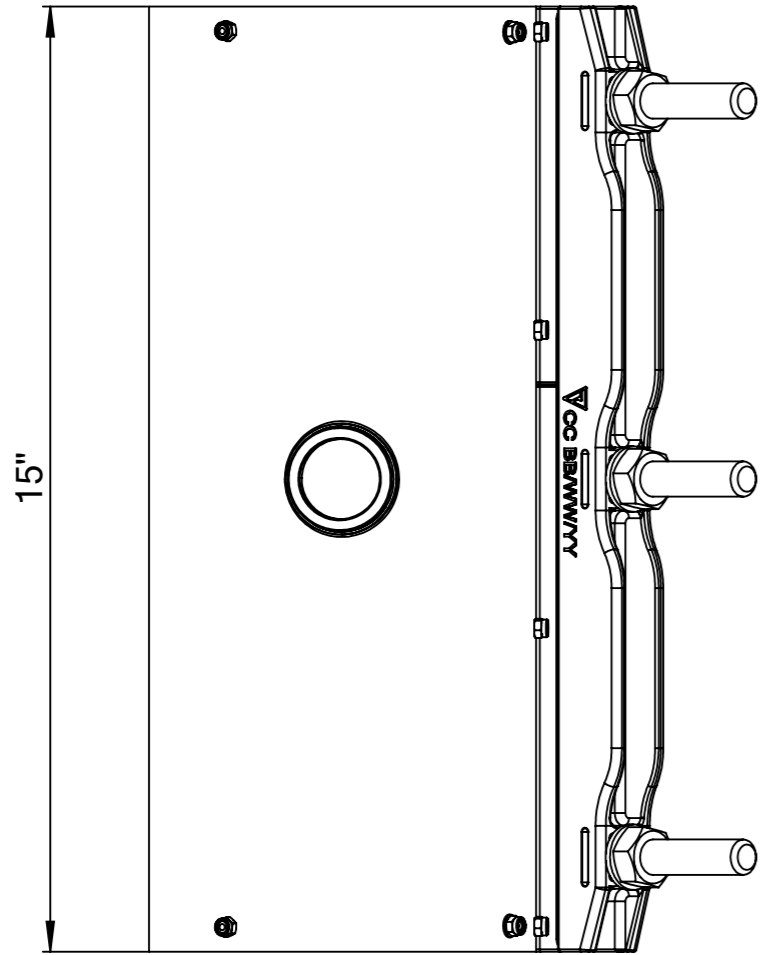

Weight:		Part Name: Hymax Clamp Outlet Thread Tap NPT/CC Length 15"		Scale
Design	Date	Name	Catalog No.	Size
Check	11/01/2017	Galy B.	SD238-56-05	A3
Appr.	29/01/2023	Tzah Gr.	Drawing No.	Sheet
			SD238-56-05	1 of 2

**RELEASED**

REVISIONS					
REV.	DESCRIPTION	ECO	DRAWN	APPROVED	DATE
A 1	Remove Clamp outlet 0.75C	-	Galy B.	Tzah. Gr.	26/12/2022

Krausz Part Number	ND	Range (inch)	H (inch)	NPT Outlet Size	CC Outlet Size	Bolts Qty.- Size d(mm)	Bolts Length L (inch)	Torque (Ft-Lbs)
238-56-0113-100N-10	4"	4.45-4.84	8	1"	/	3-M14	8.27	75
238-56-0120-100N-10		4.72-5.12	8.4	1"	/			
238-56-0125-100N-10		4.92-5.35	8.7	1"	/			
238-56-0132-100N-10	5"	5.20-5.60	9.0	1"	/	3-M14	8.27	80
238-56-0167-100C-10	6"	6.60-7.40	10	/	1"			
238-56-0174-100C-10		6.84-7.64	10.6	/	1"			
238-56-0174-200N-10		2"	/					
238-56-0218-100C-10	8"	8.60-9.40	12.4	/	1"	3-M14	8.27	95
238-56-0228-200N-10		9.00-9.80	12.8	2"	/			
238-56-0272-200N-10	10"	10.73-11.53	14.6	2"	/	3-M14	8.27	135
238-56-0288-200N-10		11.35-12.15	15.2	2"	/			
238-56-0323-200N-10	12"	12.75-13.55	16.7	2"	/	3-M16	9.45	150
238-56-0345-200N-10		13.60-14.40	17.5	2"	/			

Product performance	
Working Pressure	150 PSI
Rated Pressure	225 PSI

Weight:			Part Name: Hymax Clamp Outlet Thread Tap NPT/CC Length 15"		Scale
	Date	Name	Catalog No. SD238-56-05		Size A3
Design	11/01/2017	Galy B.	Drawing No. SD238-56-05		Sheet 2 of 2
Check	29/01/2023	Galy B.			
Appr.	29/01/2023	Tzah Gr.			

RELEASED

**KRAUSZ**  
a MUELLER brand

Confidential Information. All rights reserved to Krausz Industries Ltd. This document may not be copied, reproduced, displayed, modified or used in any way, whether in whole or in part, without the express prior written consent of Krausz Industries Ltd.

